

# \$529,000 - 634 Glenwright Crescent, Edmonton

MLS® #E4429793

**\$529,000**

4 Bedroom, 3.50 Bathroom, 1,793 sqft  
Single Family on 0.00 Acres

Glastonbury, Edmonton, AB

New paint 2 storey home located in Glastonbury. Back on the Park. Some features are the speakers in the ceiling and the smart wiring. You will find crown molding in the living room, master bedroom and half bath on the main floor. Open concept with 9' ceilings in the bonus room. There are hardwood floors in the kitchen, entry way and nook. French doors lead to the basement. The kitchen has tiled backsplash. Enjoy the main floor fireplace with tile surround and mantle. Outside you will be pleased to find a 12 ft deck and patio with a natural gas line.

Built in 1999

## Essential Information

MLS® #	E4429793
Price	\$529,000
Bedrooms	4
Bathrooms	3.50
Full Baths	3
Half Baths	1
Square Footage	1,793
Acres	0.00
Year Built	1999
Type	Single Family
Sub-Type	Detached Single Family
Style	2 Storey

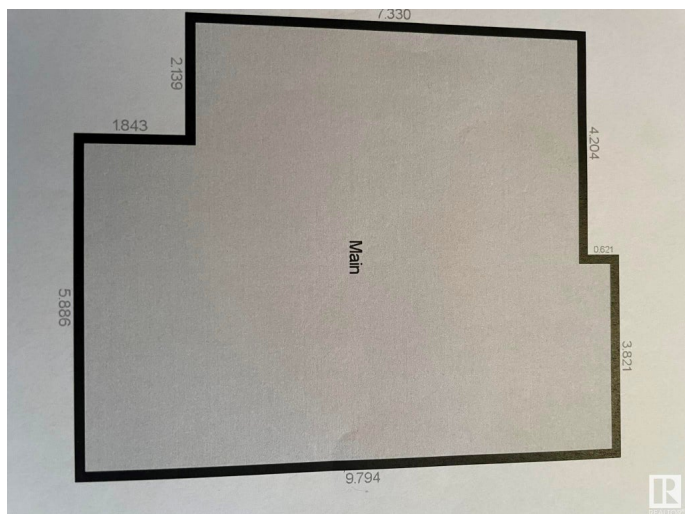

Status Active

### Community Information

Address 634 Glenwright Crescent  
Area Edmonton  
Subdivision Glastonbury  
City Edmonton  
County ALBERTA  
Province AB  
Postal Code T5T 6K7

### Amenities

Amenities Deck  
Parking Double Garage Attached

### Interior

Interior Features ensuite bathroom  
Appliances Dishwasher-Built-In, Dryer, Garage Control, Garage Opener, Hood Fan, Refrigerator, Stove-Electric, Washer, Window Coverings  
Heating Forced Air-1, Natural Gas  
Fireplace Yes  
Fireplaces Glass Door, Mantel  
Stories 3  
Has Basement Yes  
Basement Full, Finished

### Exterior

Exterior Wood, Vinyl  
Exterior Features Backs Onto Park/Trees, Fenced, Landscaped, Public Transportation, Schools  
Roof Asphalt Shingles  
Construction Wood, Vinyl  
Foundation Concrete Perimeter

### Additional Information

Date Listed April 9th, 2025  
Days on Market 4  
Zoning Zone 58  
HOA Fees 170

HOA Fees Freq. Annually

DATA IS DEEMED RELIABLE BUT IS NOT GUARANTEED ACCURATE BY THE REALTORS® ASSOCIATION OF EDMONTON. COPYRIGHT 2025 BY THE REALTORS® ASSOCIATION OF EDMONTON. ALL RIGHTS RESERVED. Trademarks are owned or controlled by the Canadian Real Estate Association (CREA) and identify real estate professionals who are members of CREA (REALTOR®, REALTORS®) and/or the quality of services they provide (MLS®, Multiple Listing Service®)

Listing information last updated on April 13th, 2025 at 4:32pm MDT