

## \$310,000 - 210 9927 79 Avenue, Edmonton

MLS® #E4429611

**\$310,000**

2 Bedroom, 2.00 Bathroom, 1,037 sqft

Condo / Townhouse on 0.00 Acres

Ritchie, Edmonton, AB

Newer and Trendy "Solstice Off Whyte" condo in Ritchie offers a luxurious suite on the 2nd floor. This open concept plan is great for entertaining! The living room has large bay windows & lots of filtered natural light. The kitchen island seats 4. Interior colours are classic neutral and in pristine condition. Hunter Douglas blinds are included. The large laundry room has ample storage space and a hanging rack. Mature flowering trees outside provide privacy and natural beauty. The south facing patio doors lead to a large balcony area (good depth), complete with gas line for BBQ and lots of space for relaxing and enjoying the weather. Close to all amenities, restaurants/coffee shops, University of Alberta, Old Strathcona Farmer's Market, shopping and entertainment. Pets subject to board approval. This 2 bed/ 2 bath (1,036.57 Sq Ft) unit includes 2 titled parking stalls (#45, #57) and 1 titled storage cage adjoining stall #57. Heated, secured basement parkade.

Built in 2007

### Essential Information

MLS® #	E4429611
Price	\$310,000
Bedrooms	2
Bathrooms	2.00

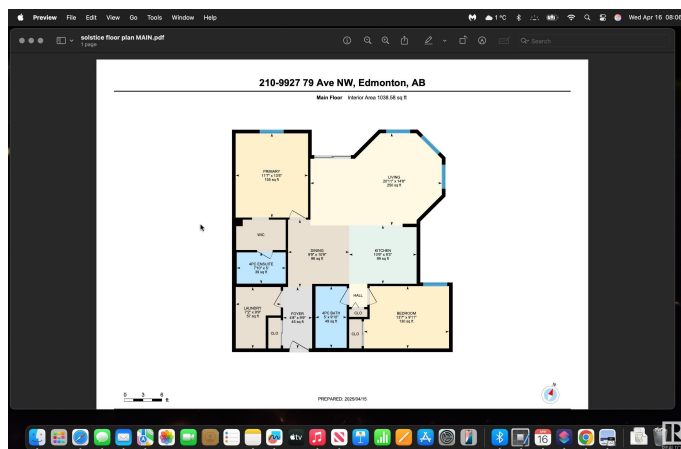

Full Baths	2
Square Footage	1,037
Acres	0.00
Year Built	2007
Type	Condo / Townhouse
Sub-Type	Lowrise Apartment
Style	Single Level Apartment
Status	Active

### Community Information

Address	210 9927 79 Avenue
Area	Edmonton
Subdivision	Ritchie
City	Edmonton
County	ALBERTA
Province	AB
Postal Code	T6E 1R3

### Amenities

Amenities	On Street Parking, Carbon Monoxide Detectors, Ceiling 9 ft., Closet Organizers, Deck, Detectors Smoke, Hot Water Natural Gas, No Smoking Home, Party Room, Secured Parking, Security Door, Sprinkler System-Fire, Storage-In-Suite, Vaulted Ceiling, Vinyl Windows, Storage Cage, Natural Gas BBQ Hookup
Parking	Heated, Parkade, Underground

### Interior

Interior Features	ensuite bathroom
Appliances	Dishwasher-Built-In, Dryer, Intercom, Microwave Hood Fan, Refrigerator, Stove-Electric, Washer, Window Coverings
Heating	Baseboard, Water
# of Stories	3
Stories	1
Has Basement	Yes
Basement	See Remarks

### Exterior

Exterior	Wood, Stone, Vinyl
Exterior Features	Flat Site, Landscaped, Level Land, No Back Lane, No Through Road, Public Transportation, Schools, Shopping Nearby

Roof	Asphalt Shingles
Construction	Wood, Stone, Vinyl
Foundation	Concrete Perimeter

### **School Information**

Elementary	Millcreek School
Middle	Ritchie Junior High

### **Additional Information**

Date Listed	April 6th, 2025
Days on Market	31
Zoning	Zone 17
Condo Fee	\$596

DATA IS DEEMED RELIABLE BUT IS NOT GUARANTEED ACCURATE BY THE REALTORS® ASSOCIATION OF EDMONTON. COPYRIGHT 2025 BY THE REALTORS® ASSOCIATION OF EDMONTON. ALL RIGHTS RESERVED. Trademarks are owned or controlled by the Canadian Real Estate Association (CREA) and identify real estate professionals who are members of CREA (REALTOR®, REALTORS®) and/or the quality of services they provide (MLS®, Multiple Listing Service®)

Listing information last updated on May 7th, 2025 at 1:17pm MDT