

\$135,000 - 5207 56 Avenue, Wetaskiwin

MLS® #E4422972

\$135,000

0 Bedroom, 0.00 Bathroom,
Single Family on 0.00 Acres

East Centennial, Wetaskiwin, AB

ATTENTION builders or investors! Imagine having ENDLESS building possibilities! Great opportunity with this R5-zoned 0.71 ACRE lot in a PRIME CUL-DE-SAC LOCATION in central Wetaskiwin! This vacant, serviced 2866 m² (30,850 sq ft) lot offers a variety of possibilities, including permitted uses such as Single Dwelling, Duplex, Triplex, Fourplex, and Accessory Buildings, among others. A fantastic, QUIET LOCATION with plenty of potential for development! Close to schools, shopping and major roadways.



Subject Property:

5211 Address	5207 56 AVE Wetaskiwin	Line No	0014196893
Lot size	2866m ² (0.71acr)	Land use	R5 - CONDOMINIUM RESIDENTIAL

Warning This property cannot be geocoded and as a result only the tax report will display for this property. Location based reports, like maps, will not function.

Reports

Essential Information

MLS® #	E4422972
Price	\$135,000
Bathrooms	0.00
Acres	0.00
Type	Single Family
Sub-Type	Vacant Lot/Land
Status	Active

Community Information

Address	5207 56 Avenue
Area	Wetaskiwin
Subdivision	East Centennial
City	Wetaskiwin
County	ALBERTA

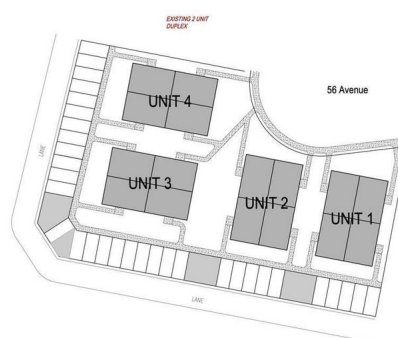

5207-56 AVENUE
WETASKIWIN, ALBERTA

Proposed Site Plan

As Approved
March 30, 2019

1-10

Province AB
Postal Code T9A 2Y3

Exterior

Exterior Features Cul-De-Sac, Flat Site, Schools, Shopping Nearby

Additional Information

Date Listed February 26th, 2025

Days on Market 43

Zoning Zone 80

DATA IS DEEMED RELIABLE BUT IS NOT GUARANTEED ACCURATE BY THE REALTORS® ASSOCIATION OF EDMONTON. COPYRIGHT 2025 BY THE REALTORS® ASSOCIATION OF EDMONTON. ALL RIGHTS RESERVED. Trademarks are owned or controlled by the Canadian Real Estate Association (CREA) and identify real estate professionals who are members of CREA (REALTOR®, REALTORS®) and/or the quality of services they provide (MLS®, Multiple Listing Service®)

Listing information last updated on April 10th, 2025 at 9:47am MDT